

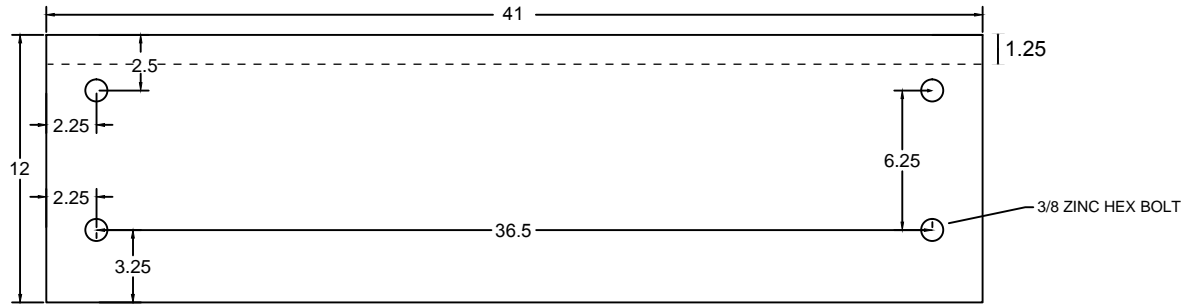

www.coastprecast.com
 Phone: 936.890.5500
 Toll Free: 877.708.7323
 Fax: 936.890.5501
 sales@coastprecast.com

Bottom View



Top View

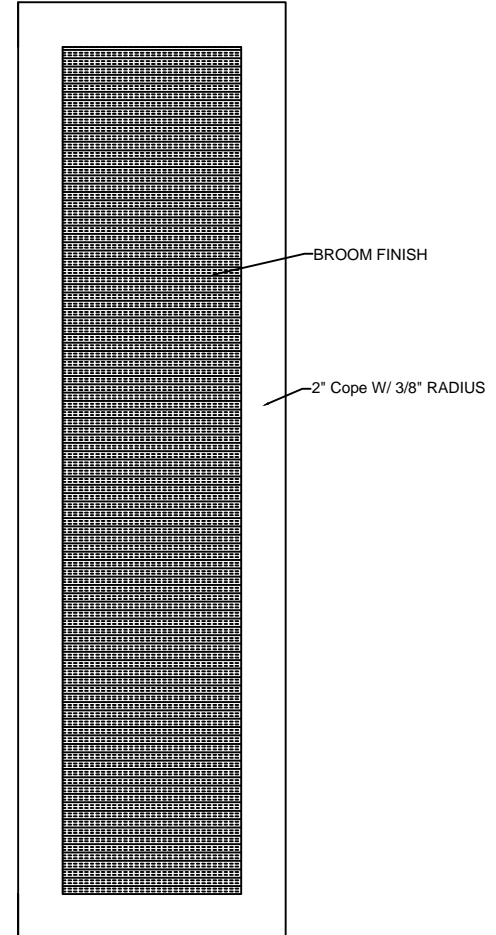

Cross Section

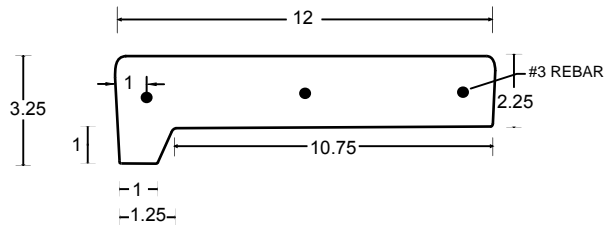

STRINGER

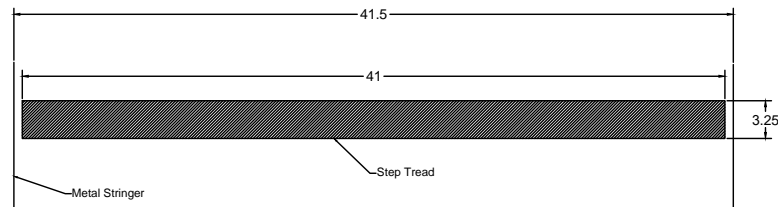

NOTES:

1. STAIR TREAD SURFACE MEETS OR EXCEEDS OSHA & ADA RECOMMENDATIONS
2. CONCRETE 5,000 LBS PSI 28 DAYS
3. LIVE LOAD 100 LBS PER SQ FOOT
4. FLEXURAL STRENGTH: 2500-3000 PSI
5. ABSORPTION 3%-4%
6. REINFORCING BARS: ASTM A615, GRADE 60

APPROVED BY: _____ DATE: _____

PRINT NAME: _____