

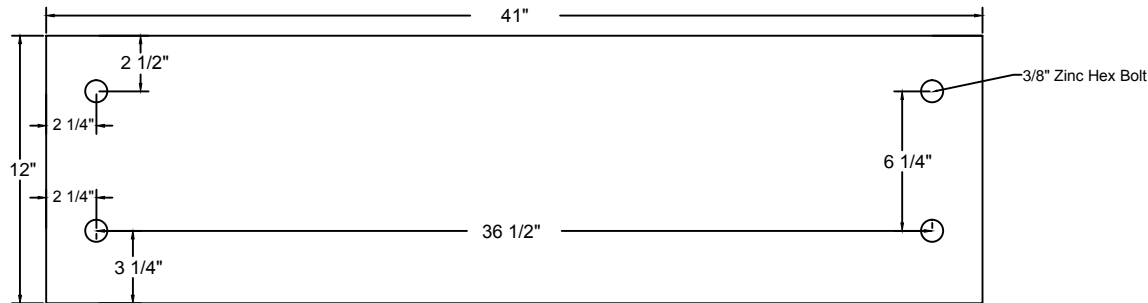

www.coastprecast.com  
 Phone: 936.890.5500  
 Toll Free: 877.708.7323  
 Fax: 936.890.5501  
 sales@coastprecast.com

### Bottom View



### Top View

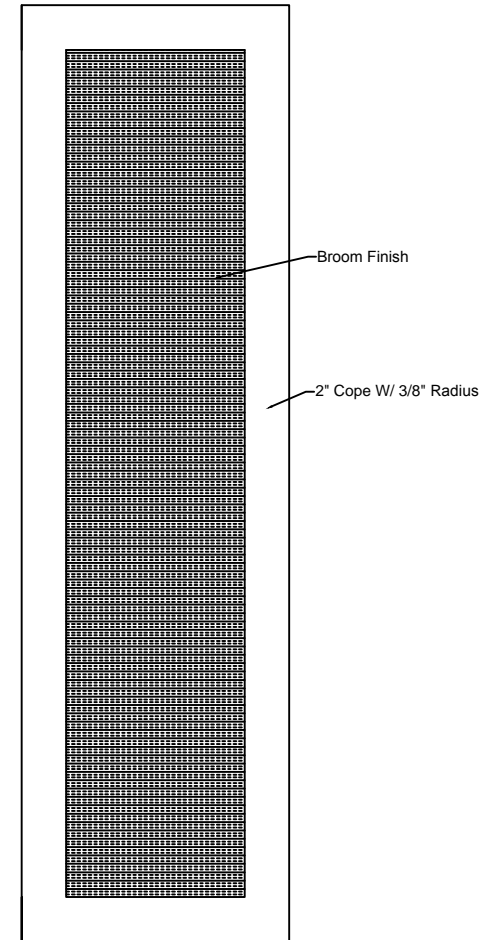

### Stringer View

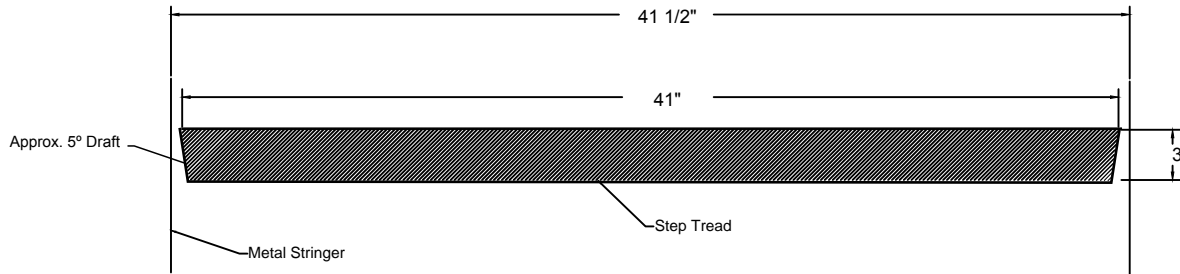

### Cross Section

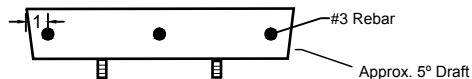

#### NOTES:

1. STAIR TREAD SURFACE MEETS OR EXCEEDS OSHA & ADA RECOMMENDATIONS
2. CONCRETE 5,000 LBS PSI 28 DAYS
3. LIVE LOAD 100 LBS PER SQ FOOT
4. FLEXURAL STRENGTH: 2500-3000 PSI
5. ABSORPTION 3%-4%
6. REINFORCING BARS: ASTM A615, GRADE 60

APPROVED BY: \_\_\_\_\_ DATE: \_\_\_\_\_

PRINT NAME: \_\_\_\_\_